

Freiflächengestaltungsplan
M 1:100

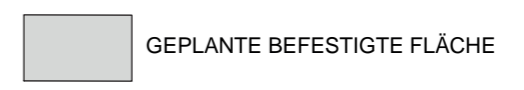
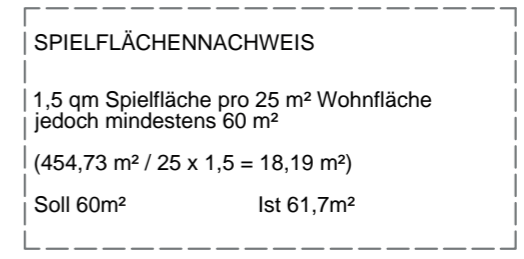
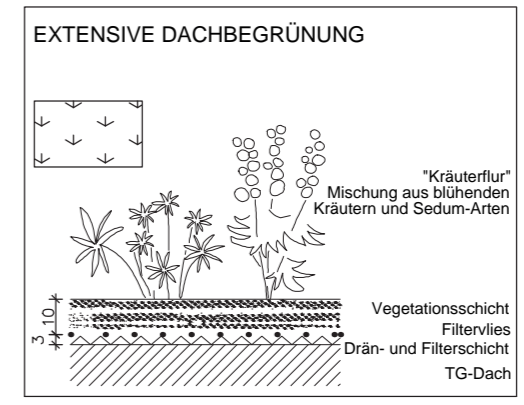
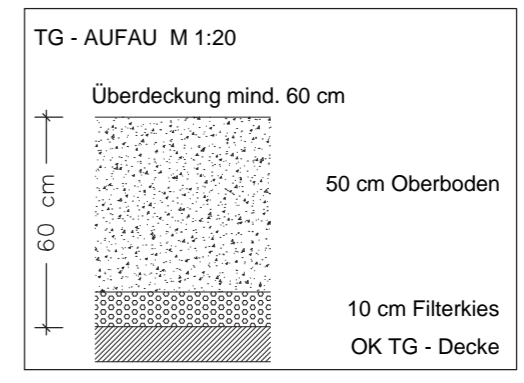
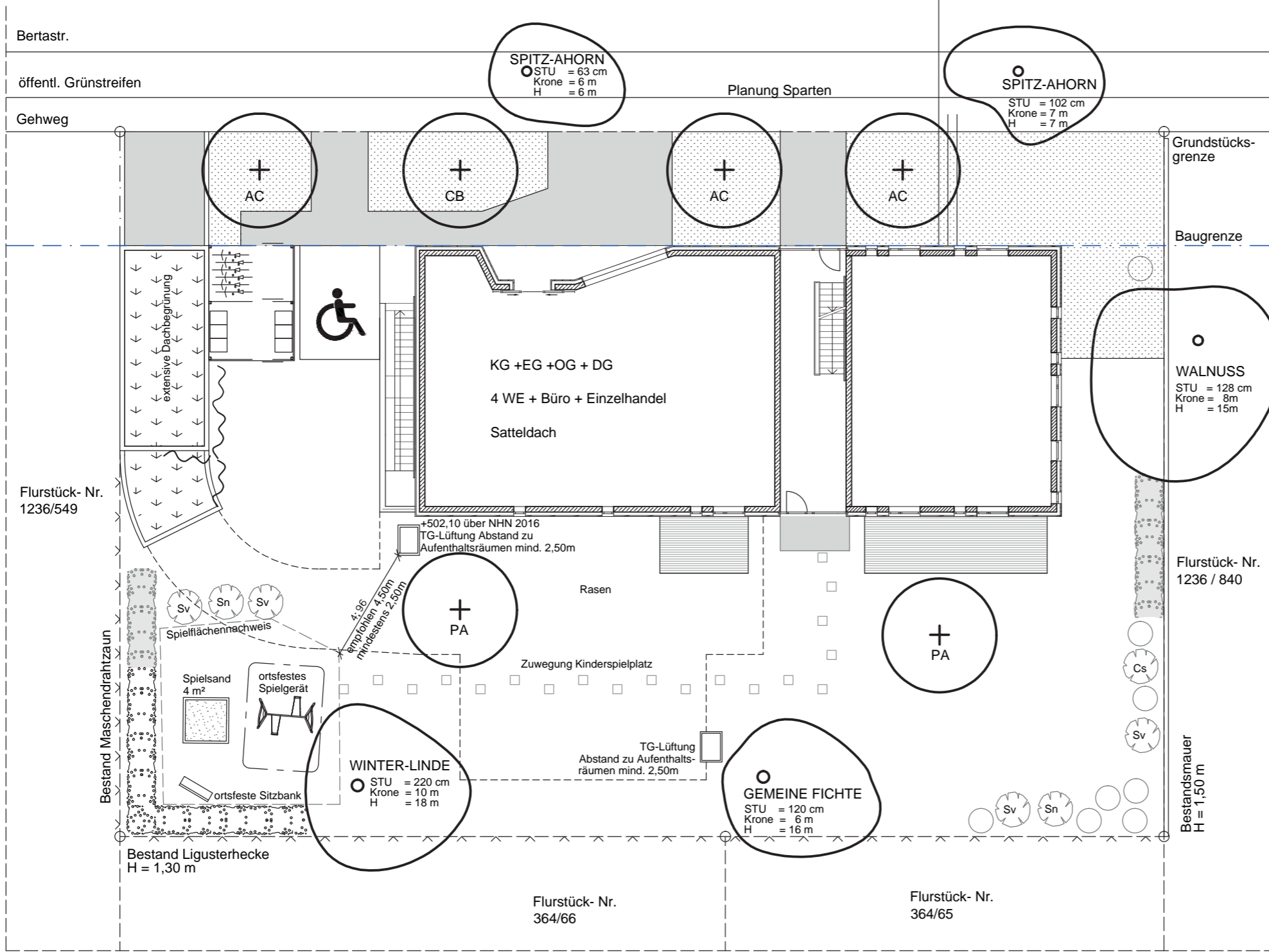

- BAUM, NEUPFLANZUNG:**
HST, 4xv. m.B. STU 20 - 25 cm
- | | | | |
|---|----|----------------------|--------------|
| 1 | CB | Carpinus betulus | Hainbuche |
| 3 | AC | Acer campestre | Feld-Ahorn |
| 2 | PA | Prunus avium 'Plena' | Wild-Kirsche |

- SOLITÄRSTRAUCH, NEUPFLANZUNG:**
3xv. m.B. H 125 - 150 cm
- | | | | |
|---|----|------------------|----------------------|
| 5 | Sv | Syringa vulgaris | Gewöhnlicher Flieder |
| 2 | Sn | Sambucus nigra | Schwarzer Holunder |
| 2 | Cs | Cornus sanguinea | Roter Hartriegel |

- BODENDECKENDE PFLANZUNG**
Kleingehölze, Stauden und Gräser
-

- HECKE, BESTAND**
-

- BAUM, BESTAND**
-

- XX**
+
-

- KLETTERPFLANZEN**
Actinidia arguta Gelber Strahlengriffel
Clematis montana 'Rubens' Anemonenwaldrabe
-

- HECKE, NEUPFLANZUNG**
Carpinus betulus Hainbuche
H = 100 - 125 cm
-

- STRAUCH, NEUPFLANZUNG (mind. 2xv, mB):**
- | | |
|---------------------|---------------------|
| Kolkwitzia amabilis | Kolwitzie |
| Viburnum lantana | Wolliger Schneeball |
| Rosa canina | Gemeine Heckenrose |
-

- XX**
-